

## OFFICES FOR LEASE

1320 Pearl Street, Boulder, CO 80302

# THE CARTWRIGHT BUILDING



### ABOUT THE BUILDING

Office suites available for lease at The Cartwright Building, an office / retail building located on the historic Pearl Street Mall. Situated between 13th and 14th across from the Boulder Court House, this building provides all of Downtown Boulder's fantastic shops and restaurants just steps away from your door.

- 296 SF - 1,075 square feet available
- Upgraded finishes throughout the building
- Rooftop deck area

#### CHAD HENRY

chenry@wwreynolds.com

#### DREW WEIMAN

drew@wwreynolds.com

THE  
*W.W. Reynolds*  
COMPANIES

P. 303-442-8687

[www.wwreynolds.com](http://www.wwreynolds.com)



1320 PEARL STREET, BOULDER, CO 80302

# THE CARTWRIGHT

THE  
*W.W. Reynolds*  
COMPANIES



SUITE 109E



Recently renovated lobby



**CHAD HENRY**

[chenry@wwreynolds.com](mailto:chenry@wwreynolds.com)

**DREW WEIMAN**

[drew@wwreynolds.com](mailto:drew@wwreynolds.com)

[WWW.WWREYNOLDS.COM](http://WWW.WWREYNOLDS.COM)  
P. 303-442-8687

THE  
*W.W. Reynolds*  
COMPANIES

1320 PEARL STREET, BOULDER, CO 80302

# THE CARTWRIGHT



## FLOOR PLAN AND SUITES

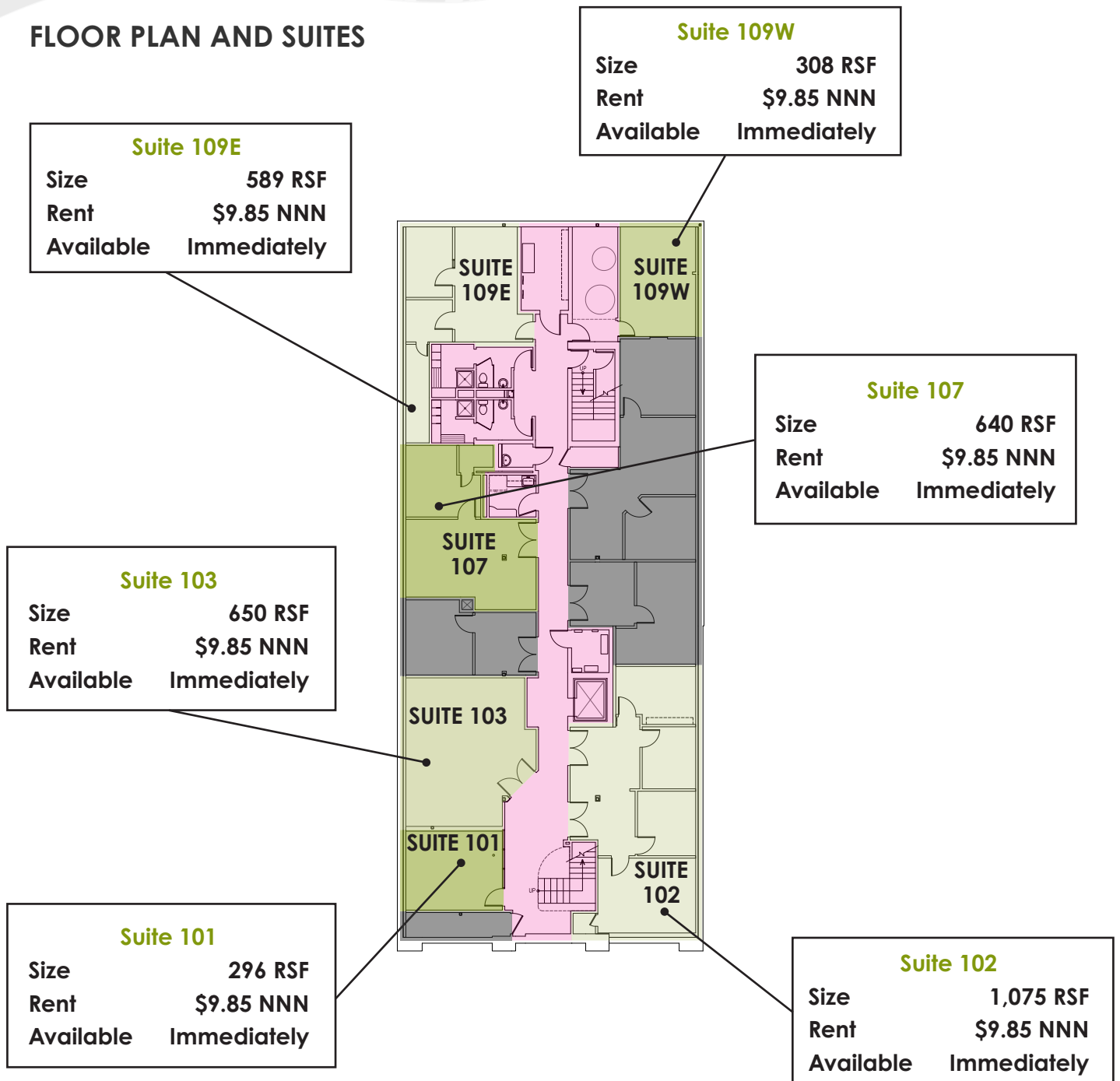

**CHAD HENRY**

chenry@wwreynolds.com

**DREW WEIMAN**

drew@wwreynolds.com